

PEDESTRIAN PATH OF TRAVEL DURING CONSTRUCTION; TURN RIGHT TO CONTINUE TO CLIFTON AND STAY STRAIGHT FOR N DECATUR

TEMPORARY CONSTRUCTION/ PEDESTRIAN DIRECTIONAL SIGNAGE

SCHOOL OF LAW

Cambrell Dr. E

N DECATUR

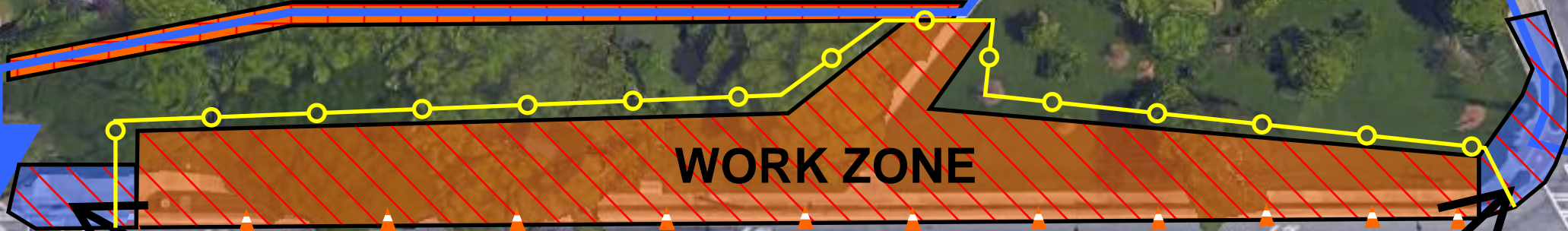

"CORNERS" COMPLETED AT OFF-HOURS TO MINIMIZE PEDESTRIAN IMPACT

Google earth